

Pos.1
Hauptmaße

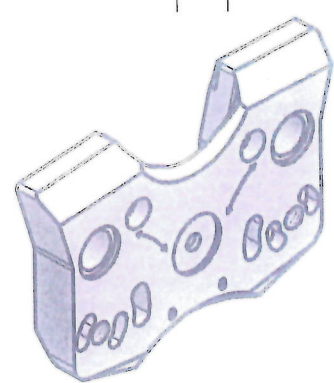
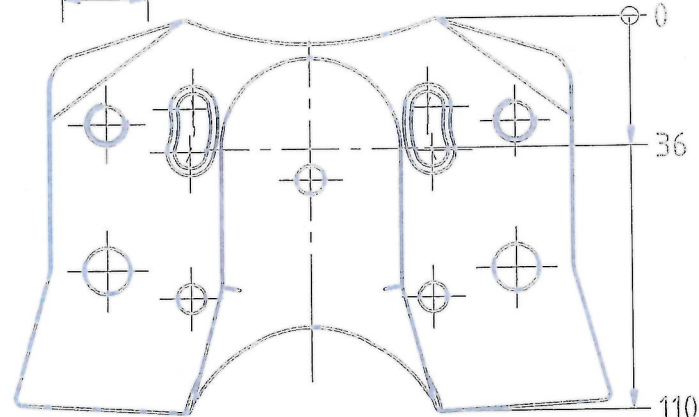
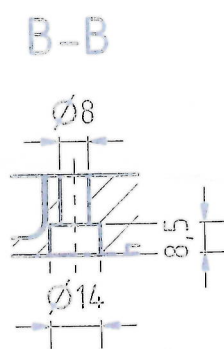
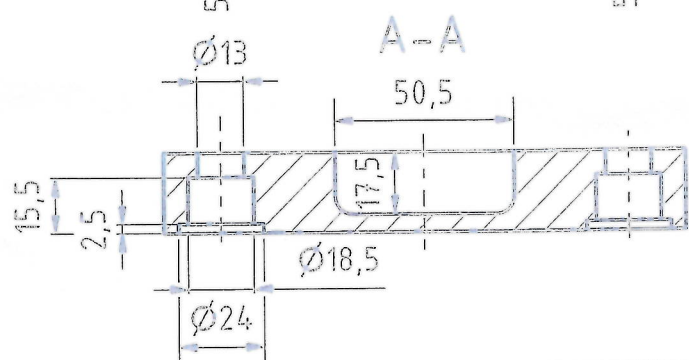
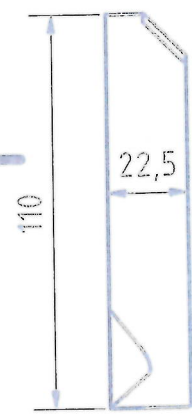
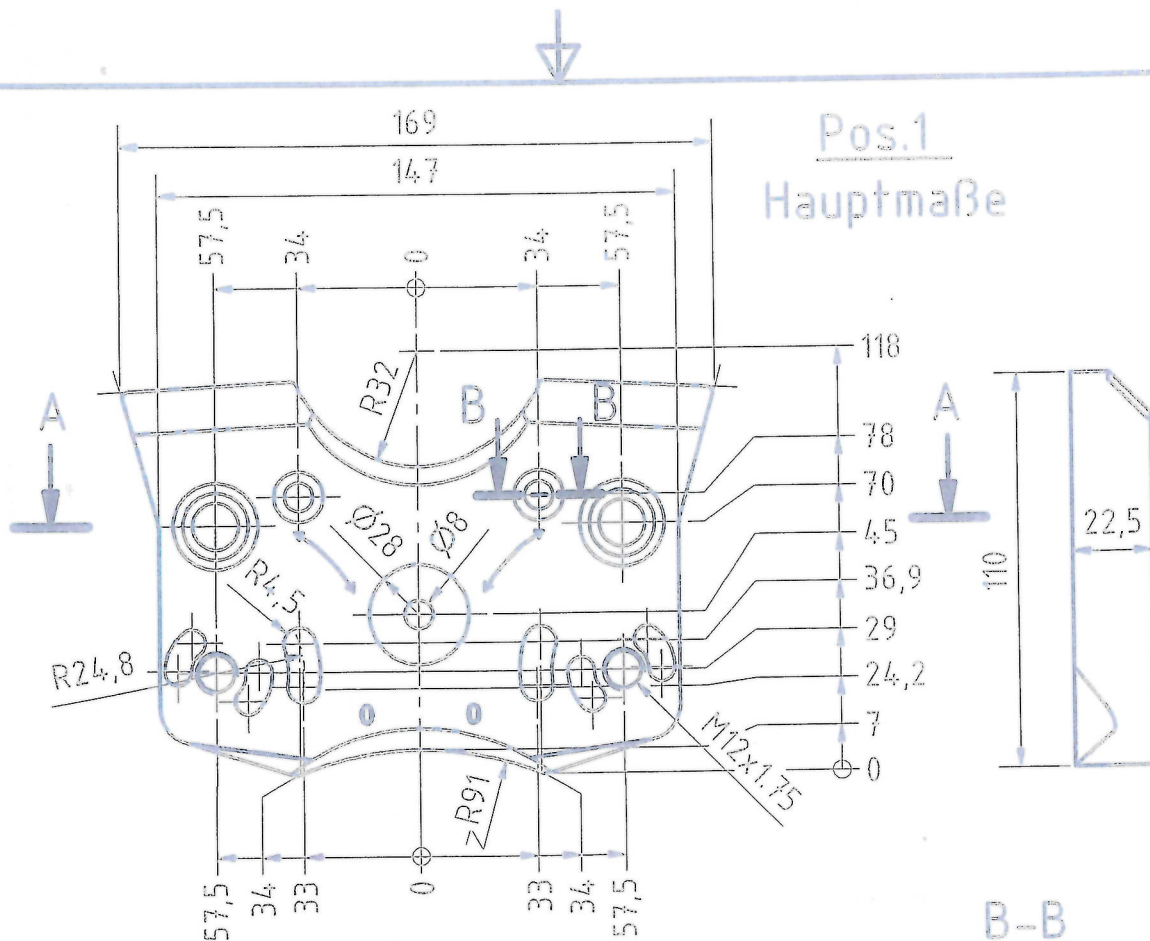

Maßstab: 1:2		Werkstoff: Al F38	
Datum 22.10.2012		Name Esser	
Gezeichnet		Kontrolliert	
23.10.2012		G.Verholen	
 www.mv-motorrad.de		Benennung: Lenkerplatte FJR 1300 ab Bj.2006	
		Ident-Nr.: 901440	Index: -
		Blatt: 3 v.5 A4	